

**Main Floor**  
 696 Sqft.  
 (Avg Ht. - 7'10")

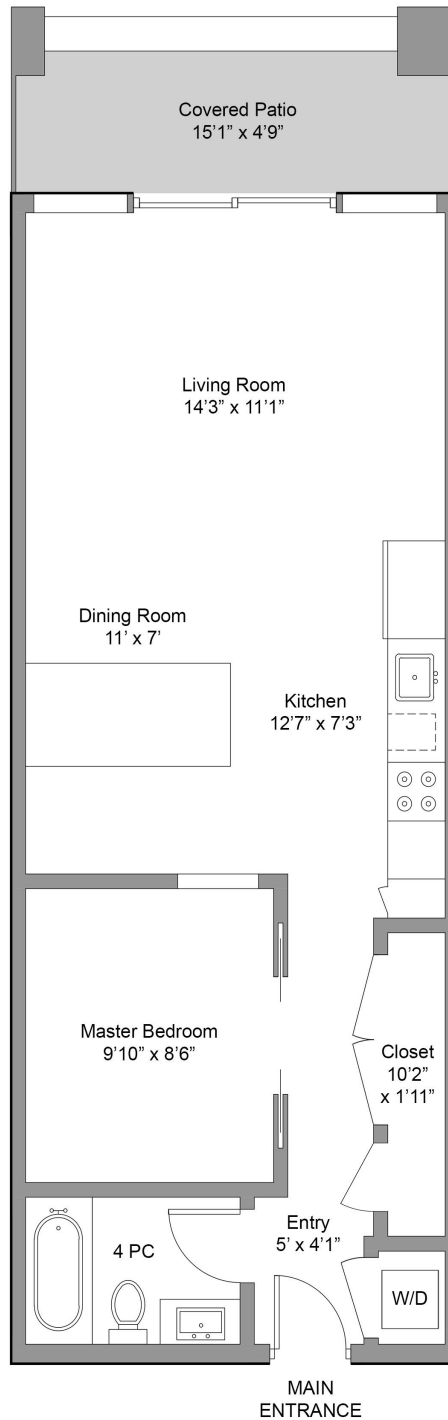

**302-517 Fisgard St.**

*This floor-plan was created for the exclusive use of  
 Nancy DiCastrì & Laurie Lidstone  
 with RE/MAX Camosun  
 Area and dimensions are approximate, buyer to verify on site.*

FLOOR	AREA (Sq. Ft.)		
	Finished	Unfinished	Garage
Main	605	91	
Total	605	91	